

# BOOST LEVEL



## INDEX

- 1. Registry code
- 2. Description
- 3. Use
- 4. Synoptic consumption per square meter
- 5. Technical specification

### 1. REGISTRY CODE

Codi	Description	Color	Measure (mm)	Weight	Pkg. / Box / Pallet
TER04-4460DK	Boost Level Cylinder	Blu	-	0,70 kg/cf.	50 pcs. / 12 bags / 144 bags

**MATERIAL**      Made of PP (Polypropylene) recycled

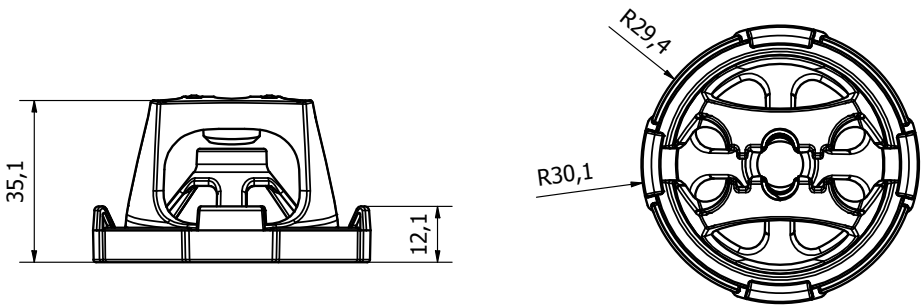

### 2. DESCRIPTION

Boost Level is an innovative screw cylinder for levelling, designed to be the fastest installation system for floor and wall tiles on the market.

- Easy and quick to use: installation is intuitive and fast. Simply insert and apply light pressure to securely connect the cylinder to the screw spacer.
- Its design allows broken screws to be automatically ejected, speeding up removal for a fast reuse.
- Self-locking clamp system: when screwing, the two clamps lay on the inner recess of the disc, ensuring a larger contact area for secure and precise installation.
- Suitable for all common spacer types - linear, T and cross spacers - making it extremely versatile on the construction site.
- Integrated anti-scratch pad protects the tile surface from damage during the leveling phase.
- Wide application range: the system supports tile thicknesses from 3 to 22 mm. For thicker tiles, from 20 to 30 mm, the dedicated linear screw TER04-4443DK is available (compatible exclusively with 3 mm spacers).

Disposable elements: single-use **linear** screws available in thicknesses of 1, 1.5, 2, 2.5, 3, and 4 mm, and **T-shaped** or cross-shaped screws in 1, 2, and 3 mm sizes.

